

FEATURES:

- ✧ Protects one bi-directional I/O line
- ✧ Low clamping voltage
- ✧ Low operating voltage: 5.0V
- ✧ ROHS compliant
- ✧ Compliant to Halogen - free



DFN0603

MAIN APPLICATIONS

- ✧ Cell Phone Handsets and Accessories
- ✧ Personal Digital Assistants (PDA's)
- ✧ Notebooks, Desktops, and Servers
- ✧ Portable Instrumentation
- ✧ Pagers
- ✧ Microprocessor based equipment

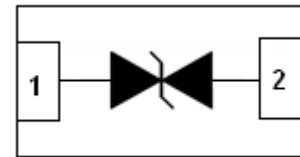

PIN Configuration

PROTECTION SOLUTION TO MEET

- ✧ IEC61000-4-2 (ESD) ±20kV (air), ±15kV (contact)
- ✧ IEC61000-4-5 (Lightning) 8A (8/20µs)

MECHANICAL CHARACTERISTICS

- ✧ Package :DFN0603
- ✧ Molding Compound Flammability Rating : UL 94V-O
- ✧ Quantity Per Reel : 10,000pcs
- ✧ Lead Finish : Lead Free
- ✧ Marking Code: AI / A5.

ABSOLUTE MAXIMUM RATINGS (T_A=25°C, RH=45%-75%, unless otherwise noted)

Parameter	Symbol	Value	Unit
Storage temperature range	T _{stg}	-55 to +150	°C
Operating junction temperature range	T _j	-55 to +125	°C
Lead Soldering Temperature	T _L	260 (10 sec.)	°C
Peak pulse power dissipation on 8/20 µs waveform	P _{PP}	80	W
ESD per IEC 61000-4-2 (Air)	V _{ESD}	+/- 20	kV
ESD per IEC 61000-4-2 (Contact)		+/- 15	

ELECTRICAL CHARACTERISTICS (T_A=25°C)

Parameter	Symbol	Conditions	Min	Typ	Max	Units
Reverse Working Voltage	V _R				5.0	V
Reverse Breakdown Voltage	V _{BR}	I _T = 1mA	5.7			V
Reverse Leakage Current	I _R	V _R = 5V			0.1	μA
Peak Pulse Current	I _{pp}	t _p = 8/20μs			8	A
Clamping Voltage	V _C	I _{PP} = 1A, t _p = 8/20μs		6.5	7	V
		I _{PP} = 8A, t _p = 8/20μs		9	10	V
Junction Capacitance	C _J	V _R = 0V, f = 1MHz		15	20	pF

Typical Performance Characteristics (T_A=25°C, unless otherwise noted)

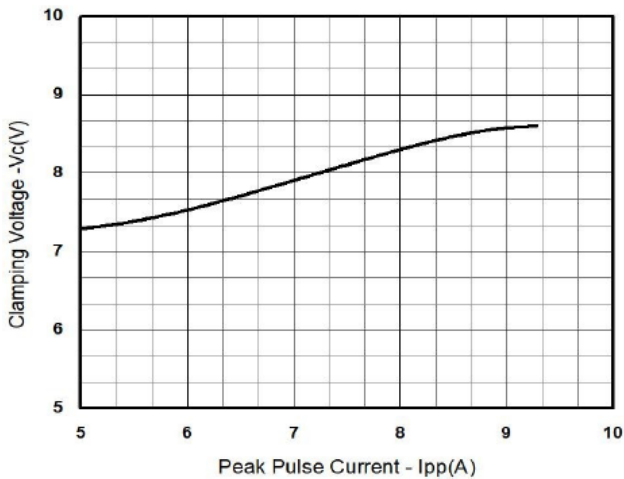

Junction Capacitance vs. Reverse Voltage

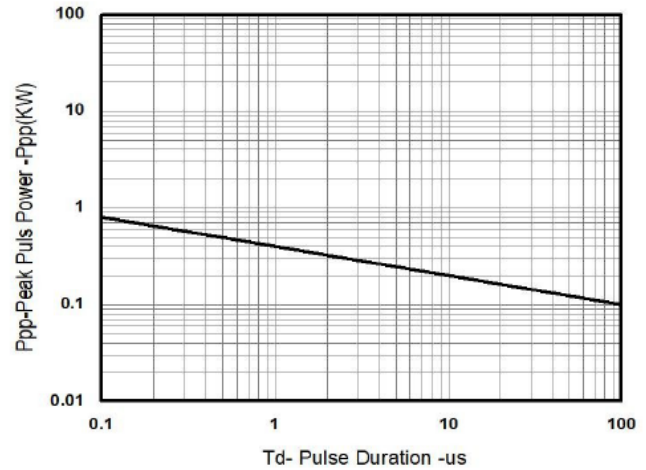

Peak Pulse Power vs. Pulse Time

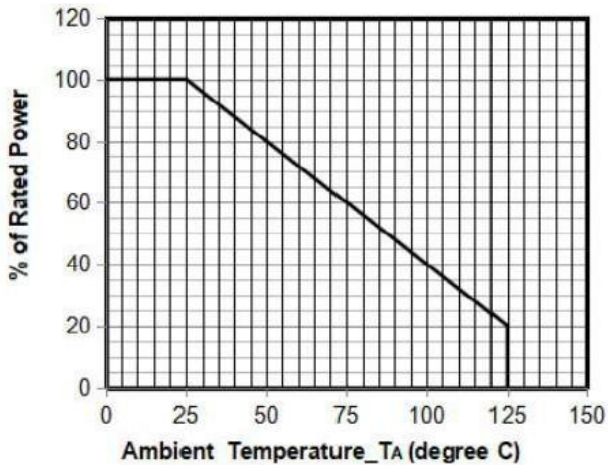

Power Derating Curve

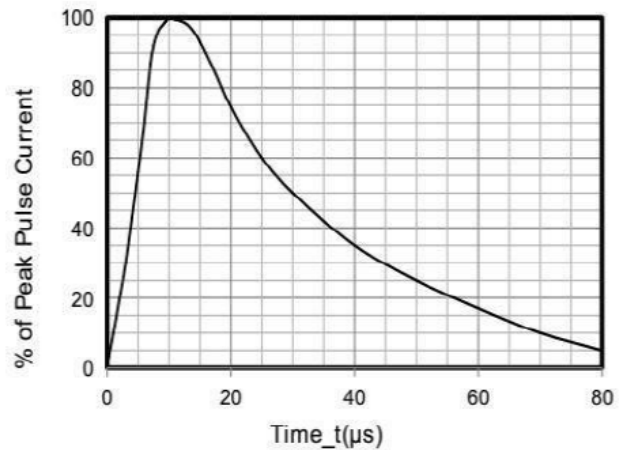

8 X 20μs Pulse Waveform

PACKAGE MECHANICAL DATA

DFN0603

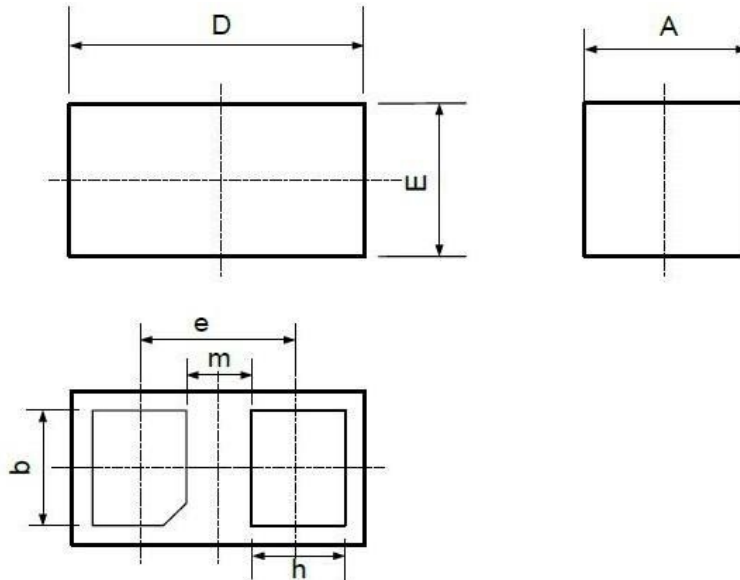

Symbol	Dimensions In Millimeters		Dimensions In Inches	
	Min	Max	Min	Max
A	0.28	0.32	0.011	0.013
D	0.55	0.65	0.022	0.026
E	0.25	0.35	0.010	0.014
b	0.20	0.30	0.008	0.012
e	0.350		0.014	
m	0.165		0.004	
h	0.07	0.17	0.003	0.007

SUGGESTED LAND PATTERN

